

**LA BUVETTE®**

Rue Maurice Perin - Z. I. de Tournes  
F-08013 CHARLEVILLE-MEZIERES Cedex FRANCE  
TEL : 03.24.52.37.20 - FAX : 03.24.52.37.24  
Int. : +33.3.24.52.37.23 Int. : +33.3.24.52.37.24  
S.A.V. : 03.24.52.37.27 - FAX : 03.24.52.37.19  
Internet : [www.labuvette.com](http://www.labuvette.com)  
e-mail : [commercial@labuvette.com](mailto:commercial@labuvette.com)  
sav [labuvette.com](mailto:labuvette.com)

# AUGES TROUGHS TRÖGE



- Lire attentivement la notice avant de commencer le montage.
- Please, read carefully the mounting instructions before mounting.
- Bevor Sie mit der Montage beginnen, lesen Sie bitte sorgfältig die Montageanleitung durch.

	<p>25 Kg / m 55 Lbs / m</p>		
	<p>1 H = 3m 1 H15 = 4m 1 H45 = 5m 2 H = 6m</p>	<p>D = <math>\varnothing</math> 9</p>	<p>a = 13 / 17 x2</p>

3 m	<p>1 D-203 + 1 D-216</p>
4 m	<p>1 D-203 + 1 D-221 + 1 D-223</p>
5 m	<p>1 D-203 + 1 D-222 + 2 D-223 + 1 D-216</p>
6 m	<p>1 D-203 + 1 D-221 + 1 D-222 + 2 D-223 + 3 D216</p>

N°4690275 - 04/12

### D-203

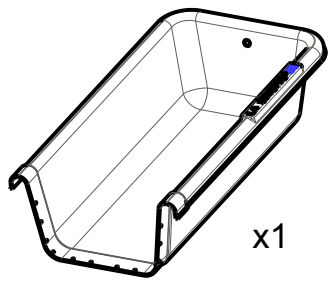

x1

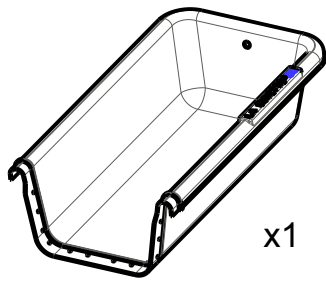

x1

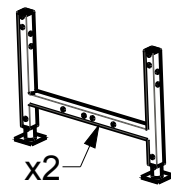

x2

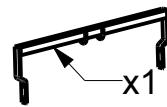

x1

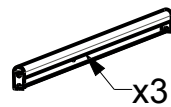

x3

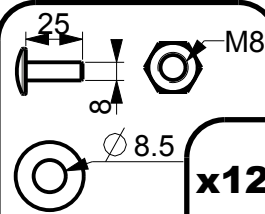

x12

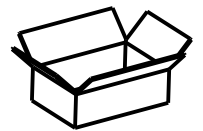

x 2

### D-204

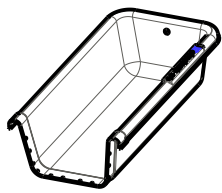

x1

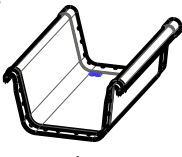

x1

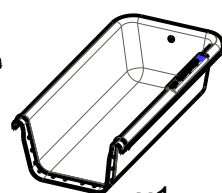

x1

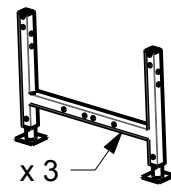

x 3

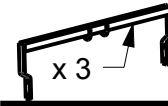

x 3



x 6

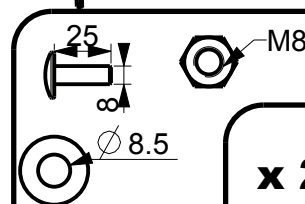

x 24

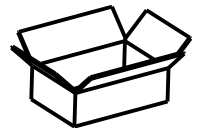

x 3

### D-205

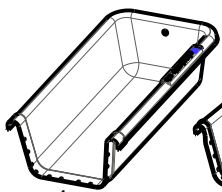

x1

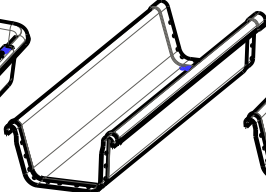

x1

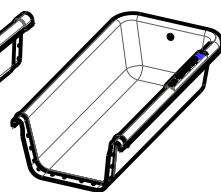

x1

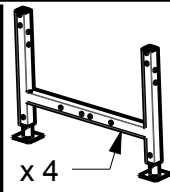

x 4

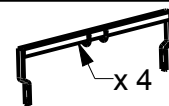

x 4



x 9

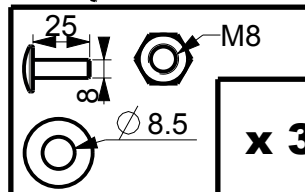

x 36

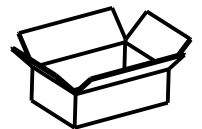

x 4

### D-206

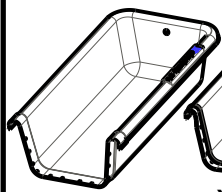

x1

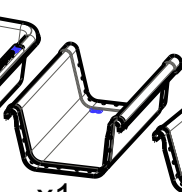

x1

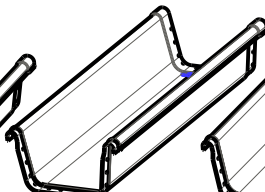

x1

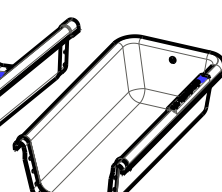

x1

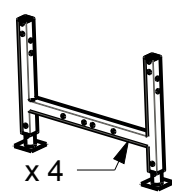

x 4

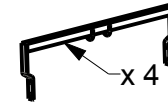

x 4



x 9

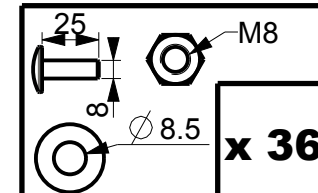

x 36

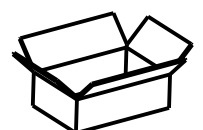

x 4

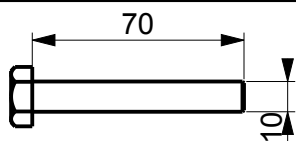
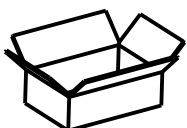

M10

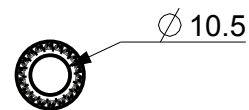

Ø 10.5

x 10



x 1

1

1-1

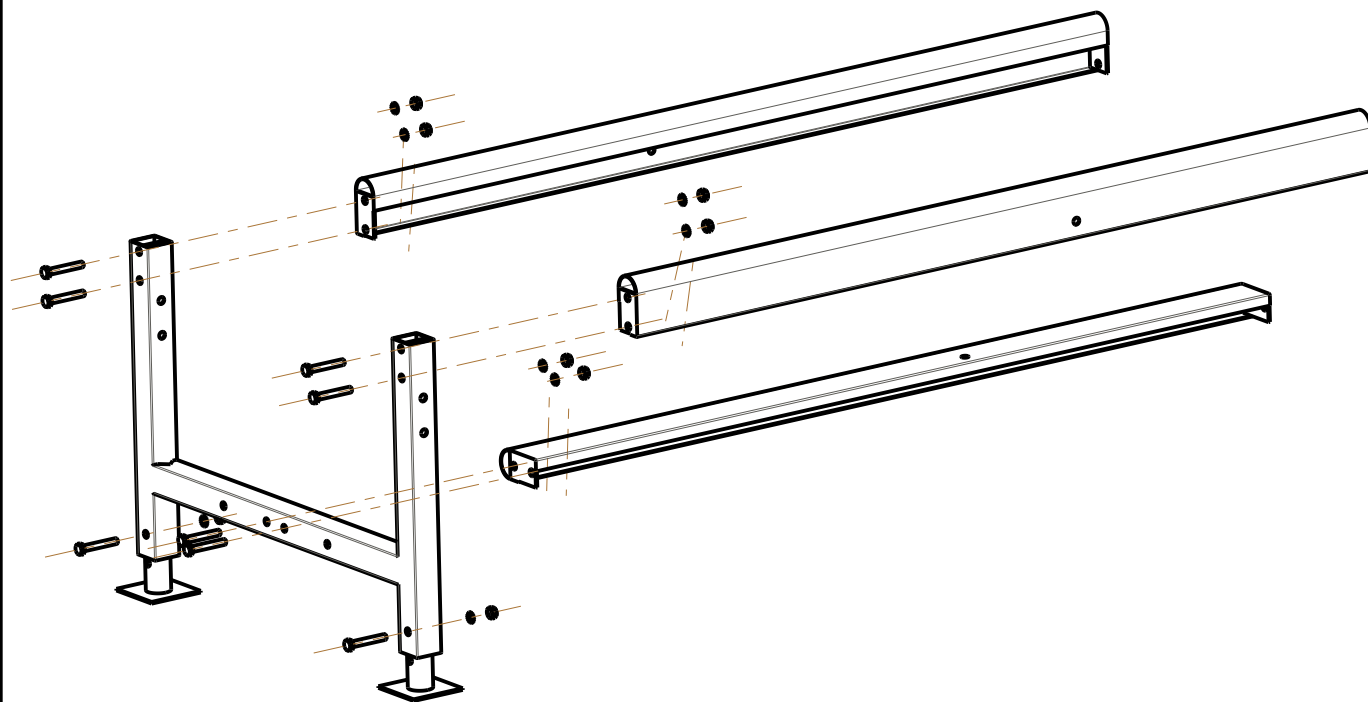
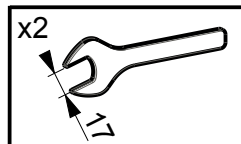
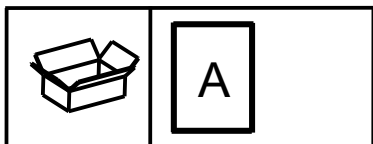

1-2

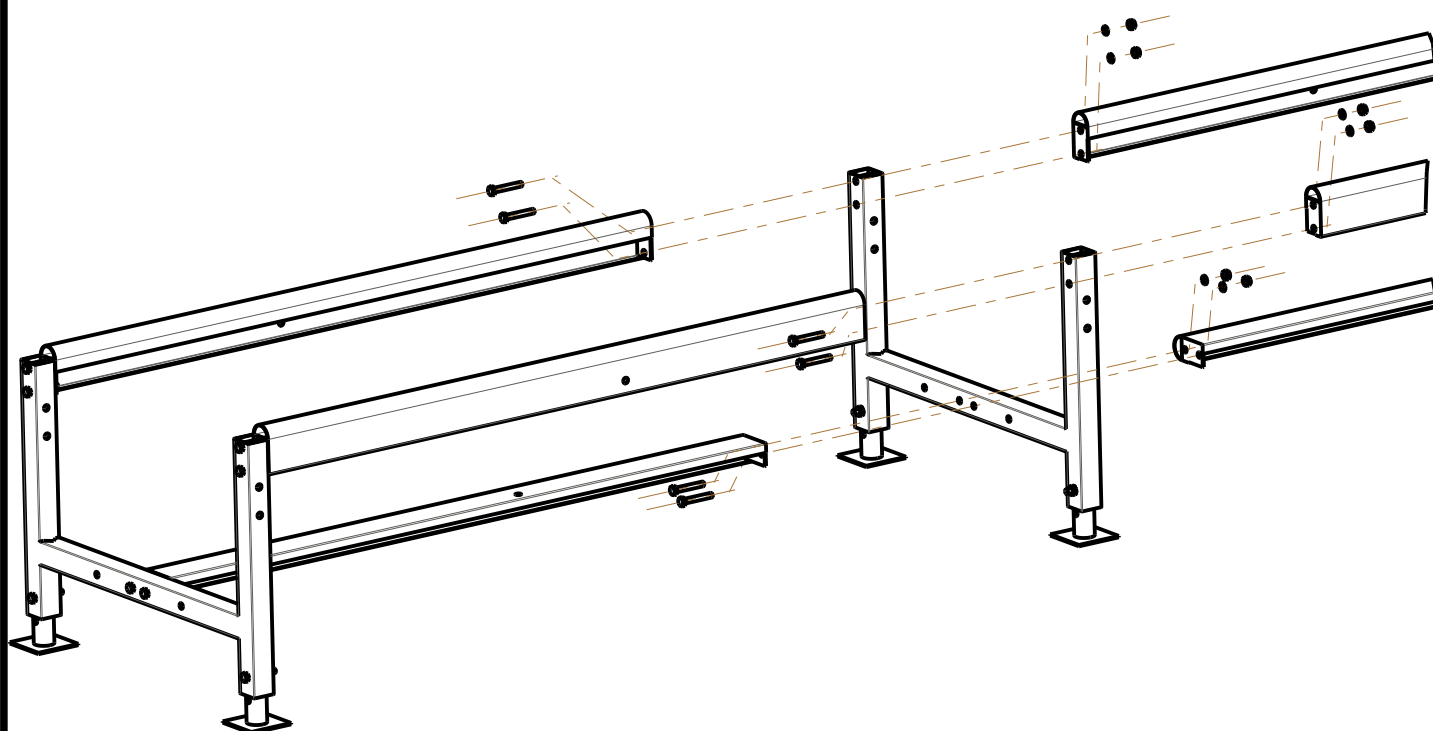

1-3



A

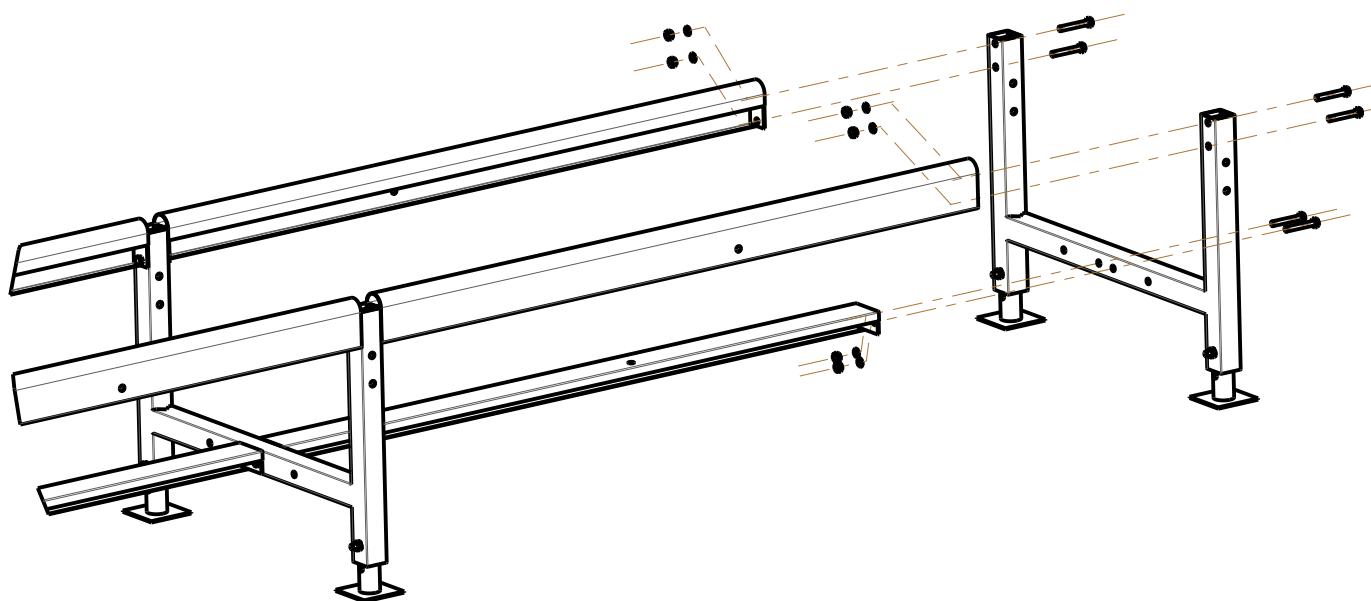
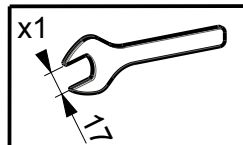

1-4

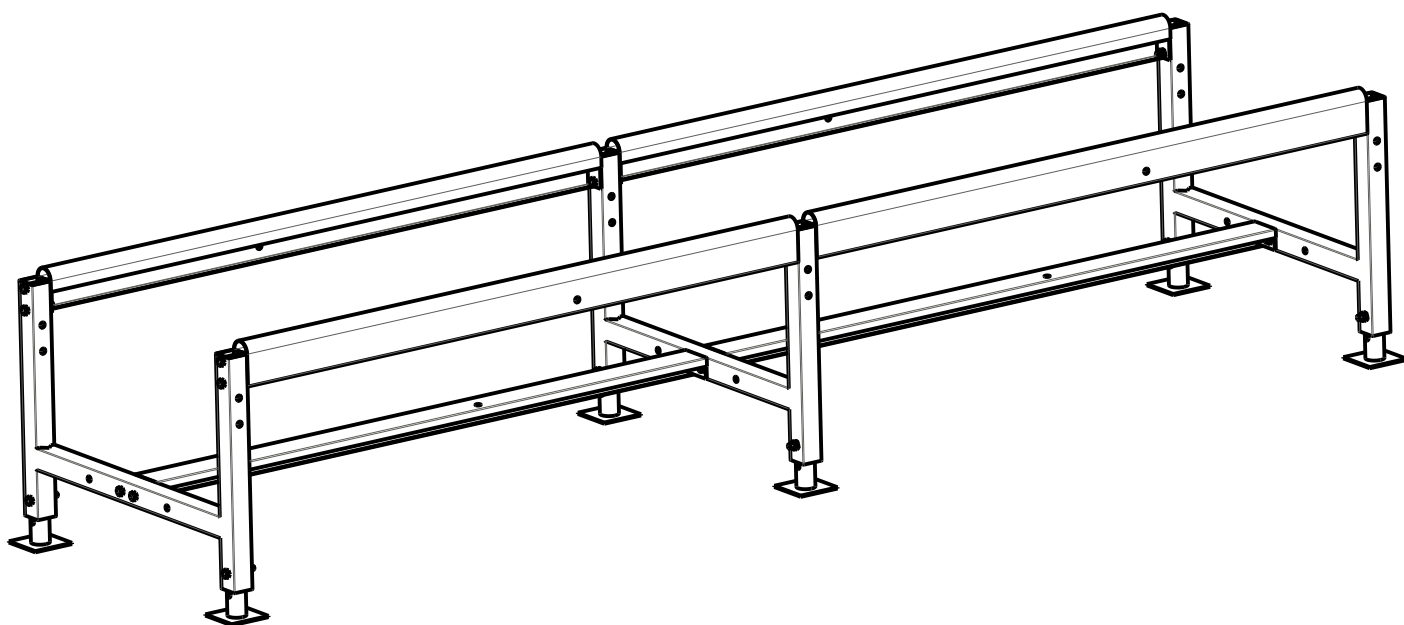

2

2-1

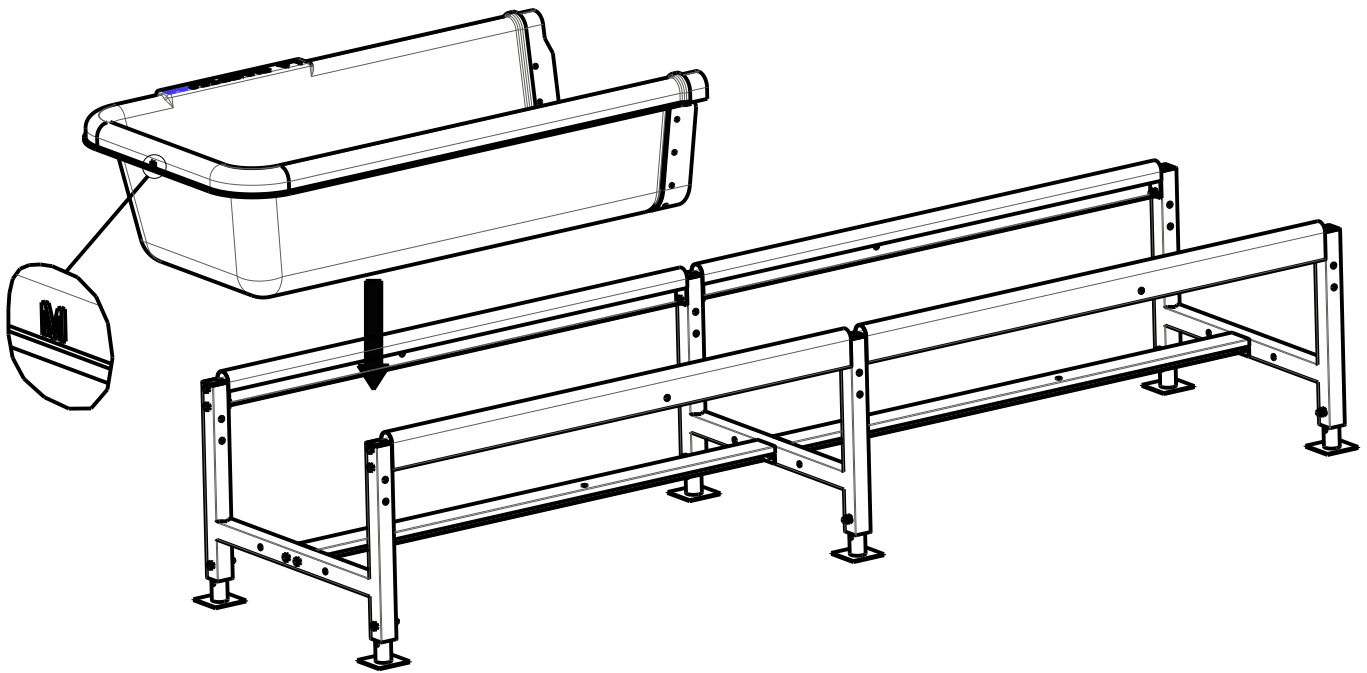

2-2

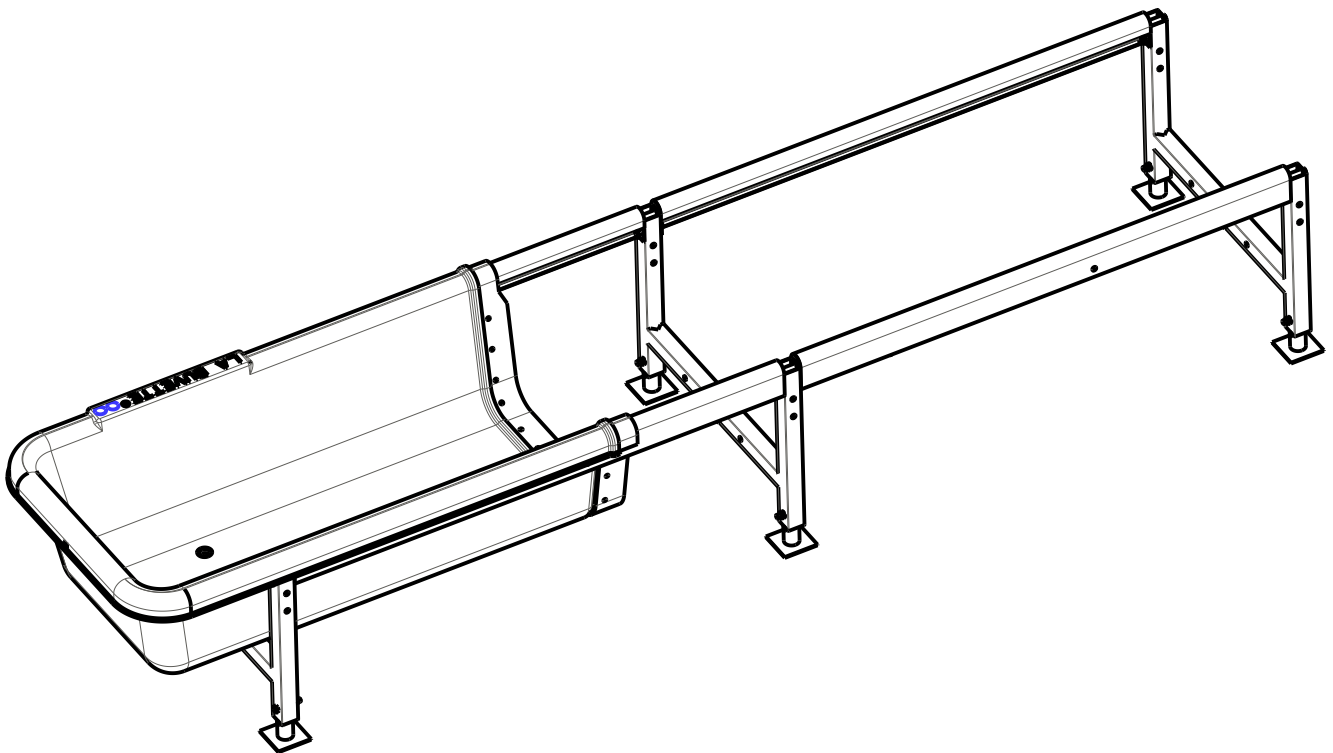

2-3

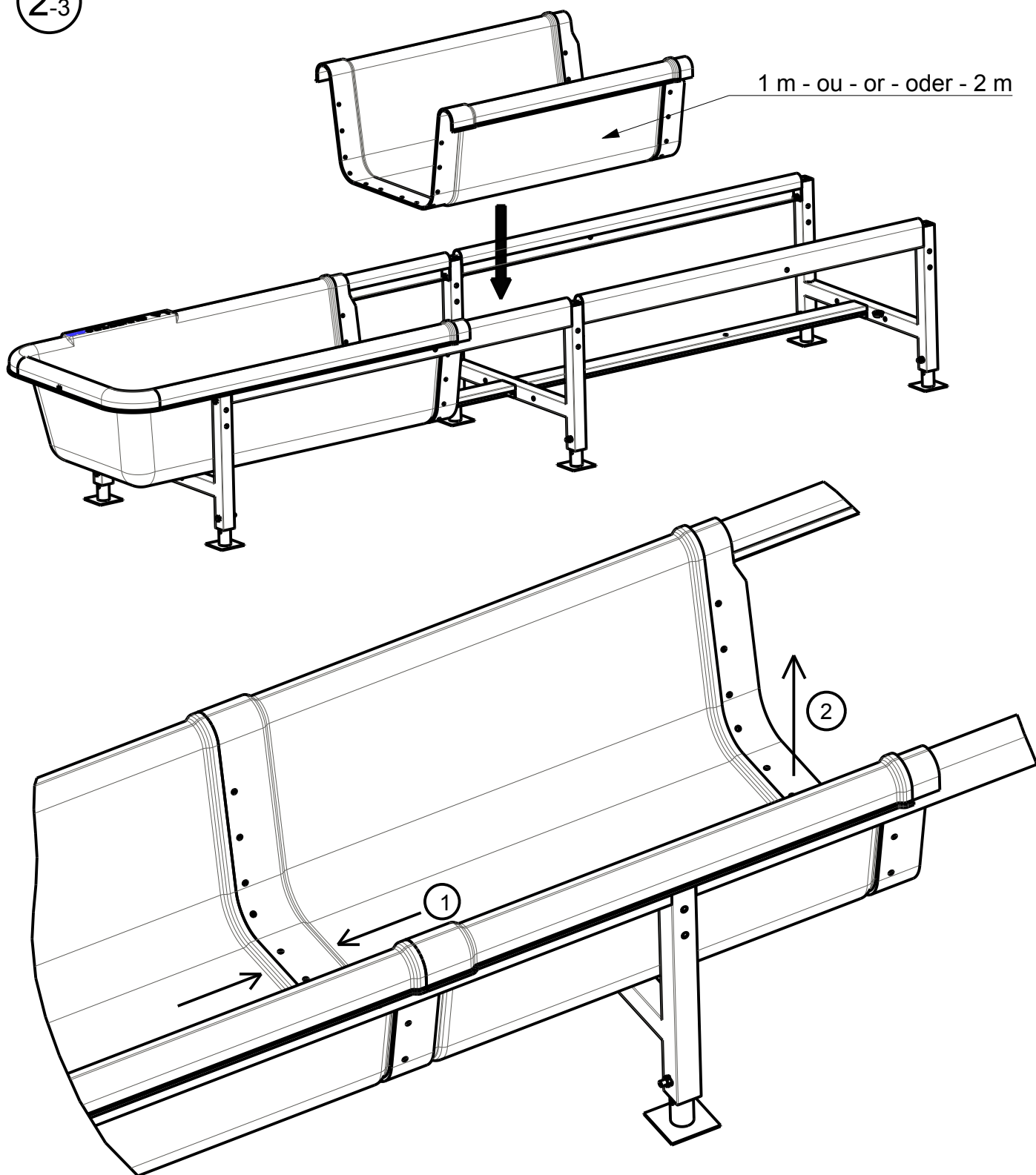

F - ① Plaquer les bords l'un contre l'autre.

② Soulever si nécessaire une extrémité de l'auge.

GB - ① Put the edge of the female end piece against the edge of the male end piece.

② If necessary lift up one end of the trough.

D - ① Die einander entsprechenden Kanten gegeneinanderlegen.

② Falls nötig ein Trogende hochheben.

3

3-1

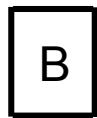
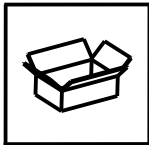

x1



x1

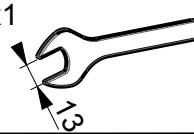

x1

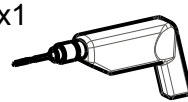

F - Percer 3 trous dans le premier rayon.  
GB - Bore 3 holes in the first radius.  
D - 3 Löcher in den ersten Radius bohren.

F - Assembler les 3 vis.  
GB - Assemble the 3 bolts.  
D - 3 Schrauben einsetzen und festschrauben.

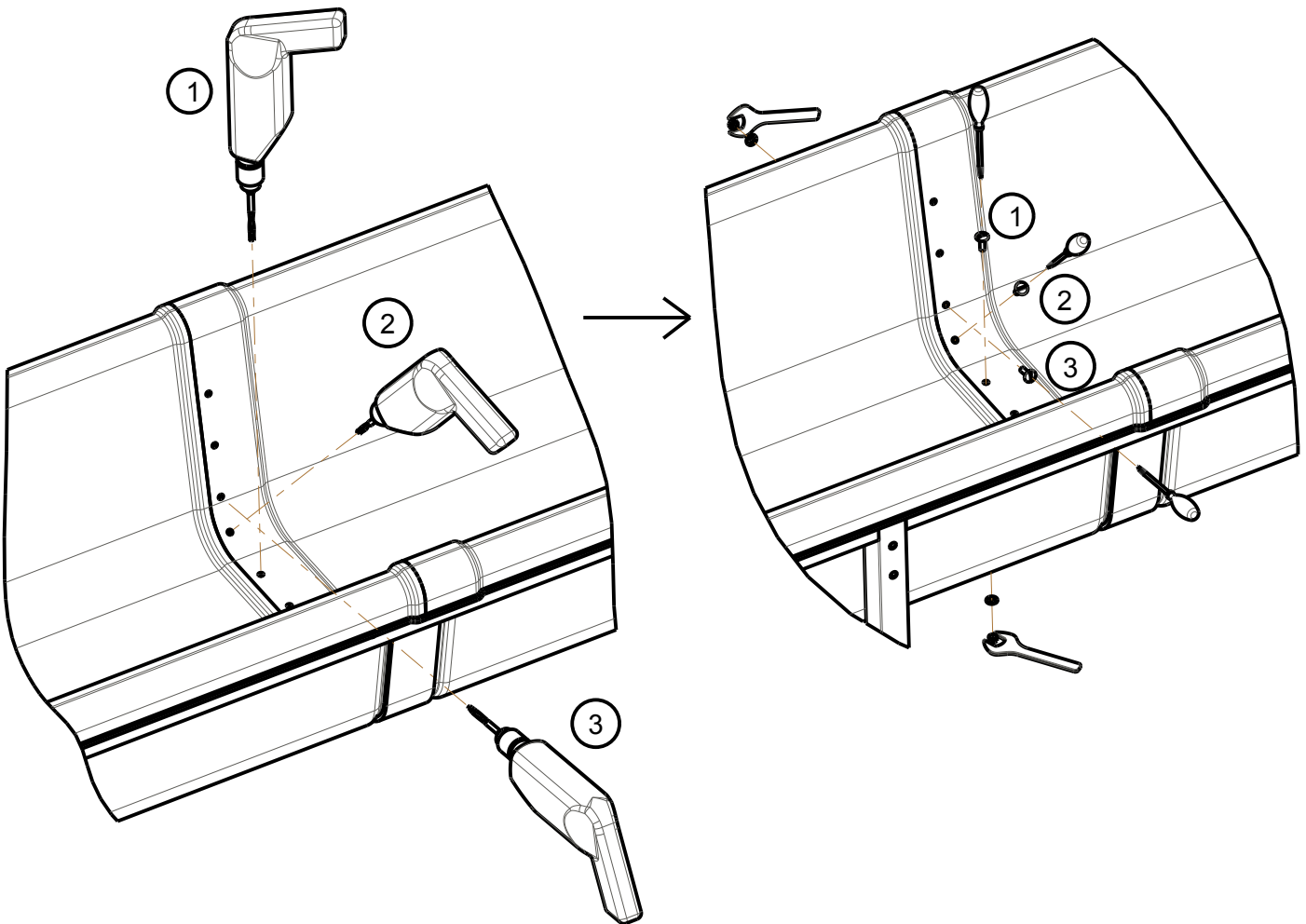

3-2

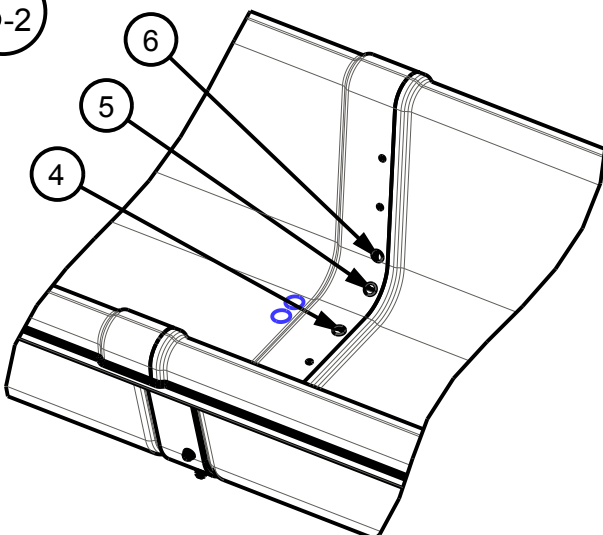

F - Percer 3 trous dans le deuxième rayon et assembler les 3 vis.  
GB - Bore 3 holes in the second radius and assemble the 3 bolts.  
D - 3 Löcher in den zweiten Radius bohren und 3 Schrauben einsetzen und festschrauben.

3-3

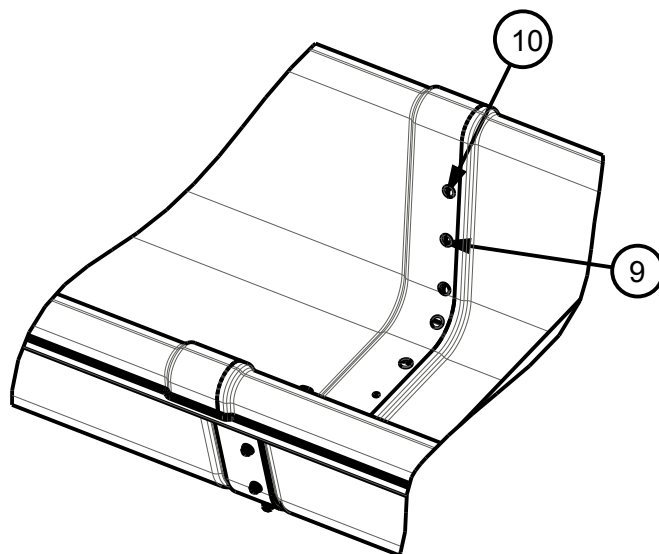
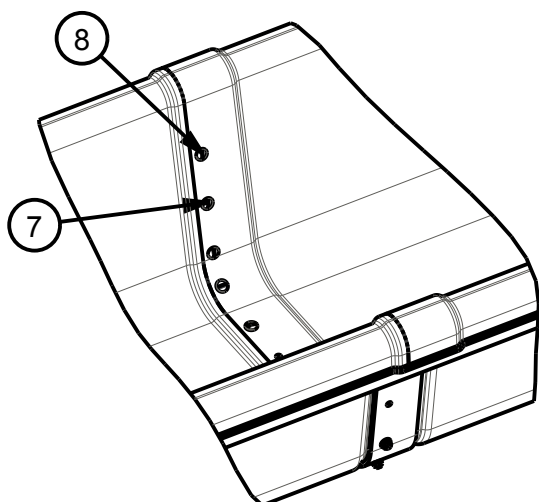

- F - Percer les parties verticales, puis assembler (soulever si nécessaire une extrémité de l'auge).  
 GB - Bore the vertical parts, then assemble (lift up if necessary one end of the trough).  
 D - Löcher in die gekennzeichneten seitlichen Stellen bohren, dann zusammenschrauben.  
 (falls nötig ein Trogende hochheben)

3-4

- F - Percer les trous du fond et assembler.  
 GB - Bore the holes on the bottom and assemble.  
 D - Löcher in die gekennzeichneten Stellen auf dem Trogboden bohren und zusammenschrauben.

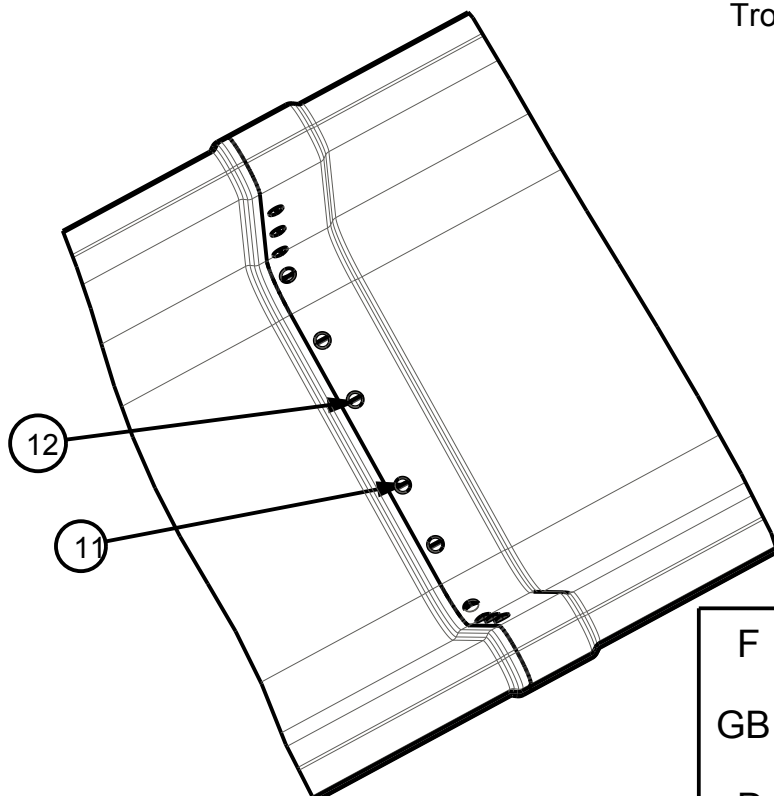

- F - Procéder de la même manière pour les autres liaisons.  
 GB - Same procedure for the other connections.  
 D - Für den restlichen Zusammenbau in derselben Weise vorgehen.



4

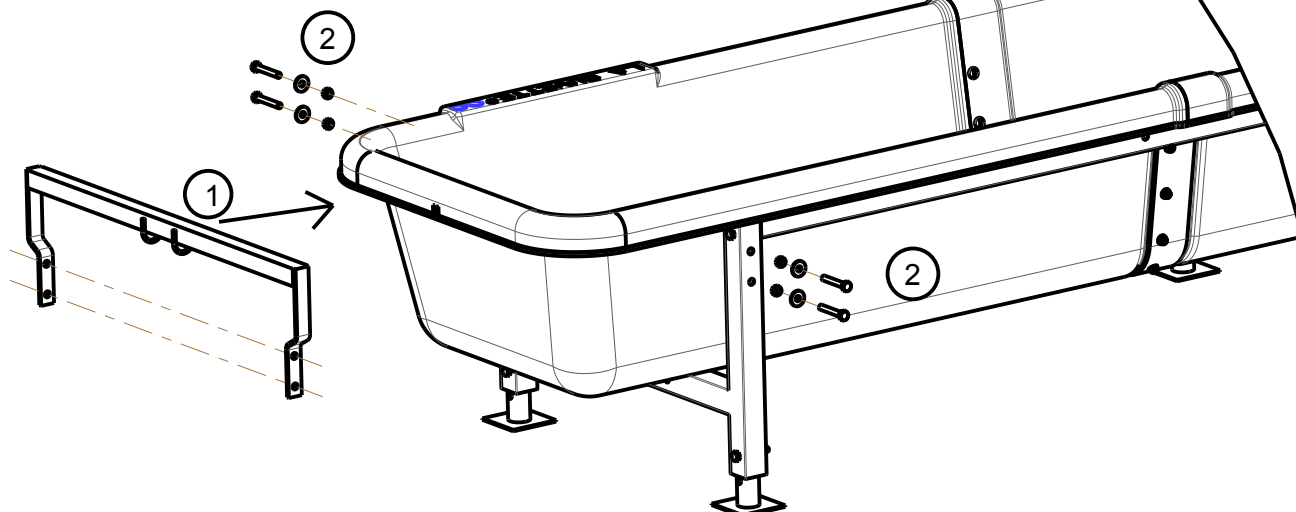
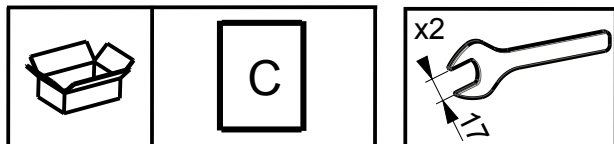

5

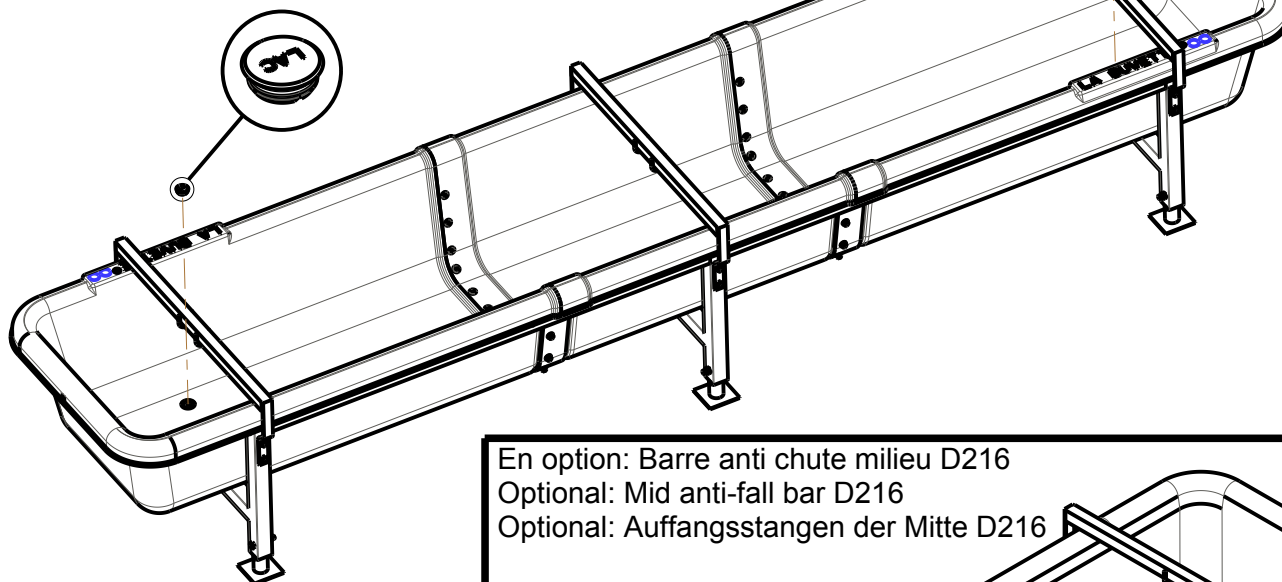
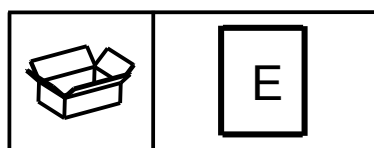

En option: Barre anti chute milieu D216  
Optional: Mid anti-fall bar D216  
Optional: Auffangsstangen der Mitte D216

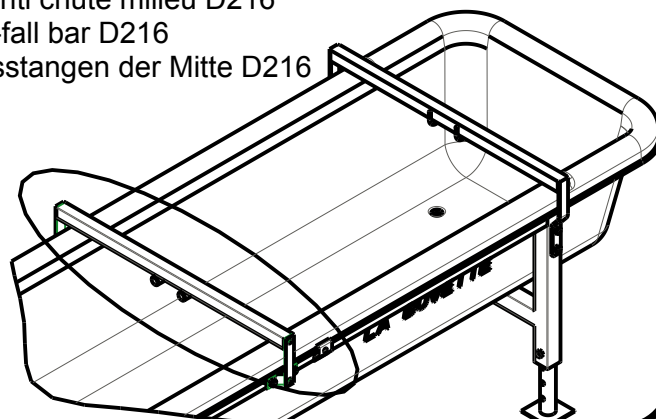

3 m	<div>D 203</div> <div>x 1</div>
4 m	<div>D 204</div> <div>x 1</div>
5 m	<div>D 205</div> <div>x 1</div>
6 m	<div>D 206</div> <div>x 1</div>
7 m	<b>Nous contacter / contact us / Setzen Sie sich in Verbindung mit uns</b>
8 m	<b>Nous contacter / contact us / Setzen Sie sich in Verbindung mit uns</b>
9 m	<b>Nous contacter / contact us / Setzen Sie sich in Verbindung mit uns</b>
10 m	<b>Nous contacter / contact us / Setzen Sie sich in Verbindung mit uns</b>
11 m	<b>Nous contacter / contact us / Setzen Sie sich in Verbindung mit uns</b>
12 m	<b>Nous contacter / contact us / Setzen Sie sich in Verbindung mit uns</b>